

Installation Instructions for (2011-2014 Mustang) nGauge A/C Magnetic Vent Mount



Note: This manual assumes dash trim piece has been taken off and wiring harness for nGauge has been routed towards the driver side air-vent. There are several videos and tutorials on youtube.com that will describe how.

Components:

- 1 x nGauge Adapter Plate
- 1 x Mount Back Piece
- 1 x Mount Inner Piece
- 2 x #6-32 Countersink Screws, 1.5" Length
- 2 x #6-32 Steel Hex Nuts
- 1 x nGauge (NOT INCLUDED)



Step 1: With the dash, gauge trim piece taken off the car, flip trim piece over and remove the air vent. Leave the chrome ring in place. See images below.



Lift clips around the ring, being very careful not to apply too much pressure or they will break off easily, and pull air vent upwards. Once free from clips, vent can be removed.



Step 2: With air vent removed from dash trim piece, remove front directional vents by popping each vent rod out its respective socket.

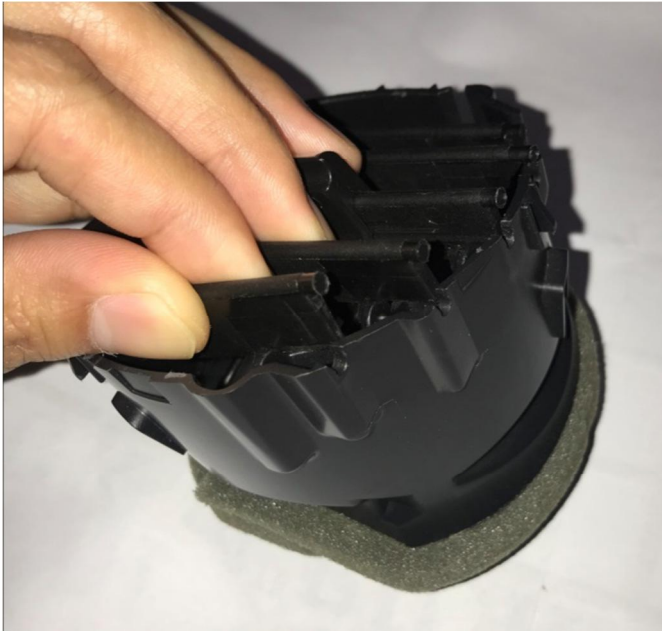

Step 3: Now that the inner directional vents can be accessed, pop out the inner directional vent rods from each socket, see image below for more detail.



Inner directional mounts need to be pulled down first, and then out as shown in the figure below.



Step 4: With the directional vents removed, the Back Piece and Inner Piece can now be installed into the vent. Please note the orientation of the vent. Image below shows the front facing view of the vent.



UP^



Speedometer and
Tachometer would
be here

Exploded view of assembly. Please note orientation of parts in respect to assembly.

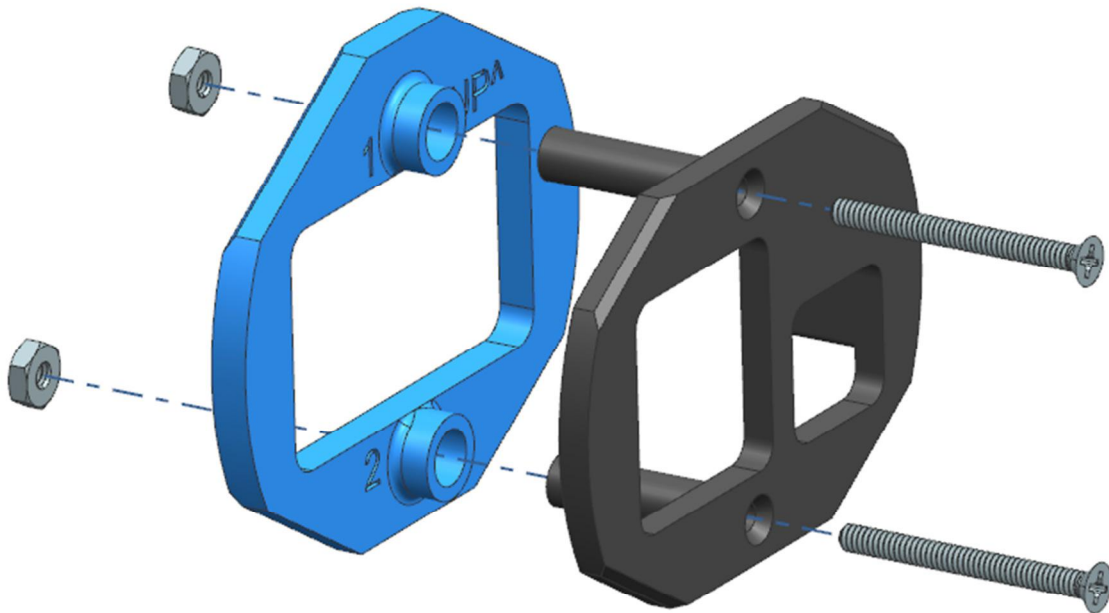

Please note part marking on parts for assembly. 1 to 1. 2 to 2.

Back Piece

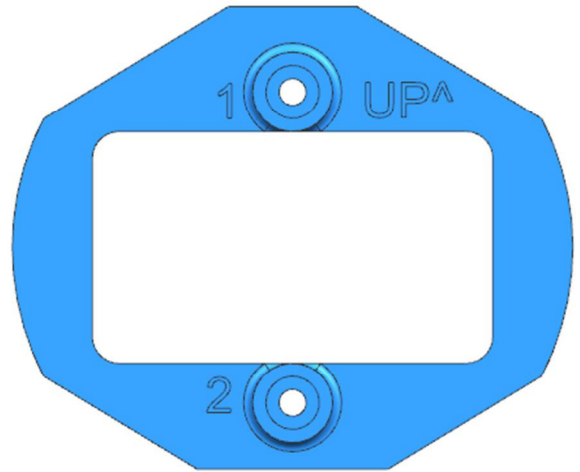

Inside Piece

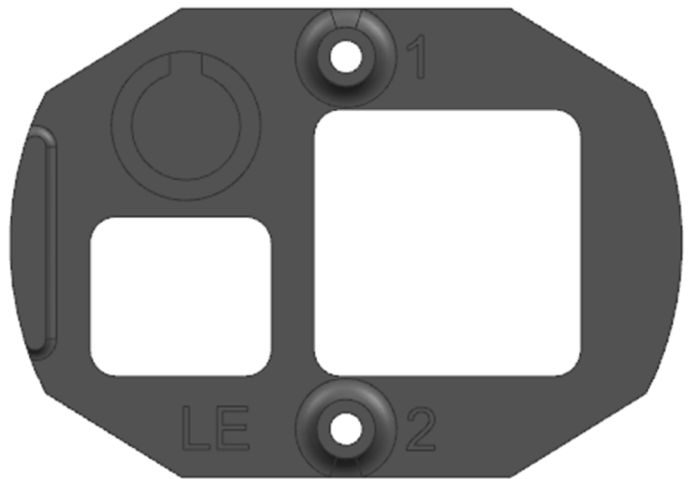

Place back piece into backside of vent mount, see images below.

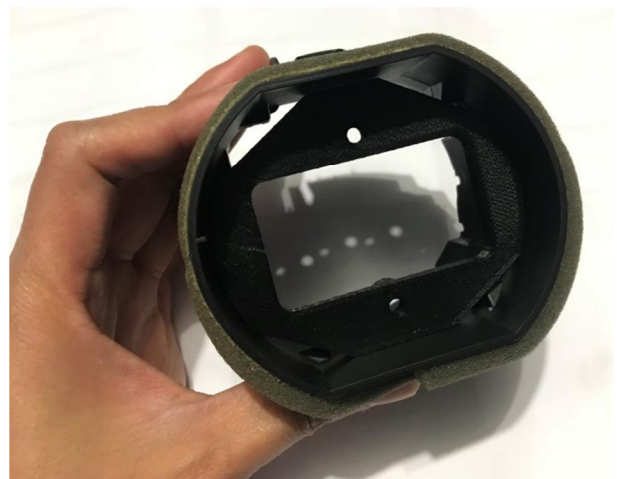

Insert inside piece through front side of the vent, make sure to line up 1 to 1 and 2 to 2. Secure into place with the provided (2)6-32 fasteners and (2)hex nuts. Do not overtighten!

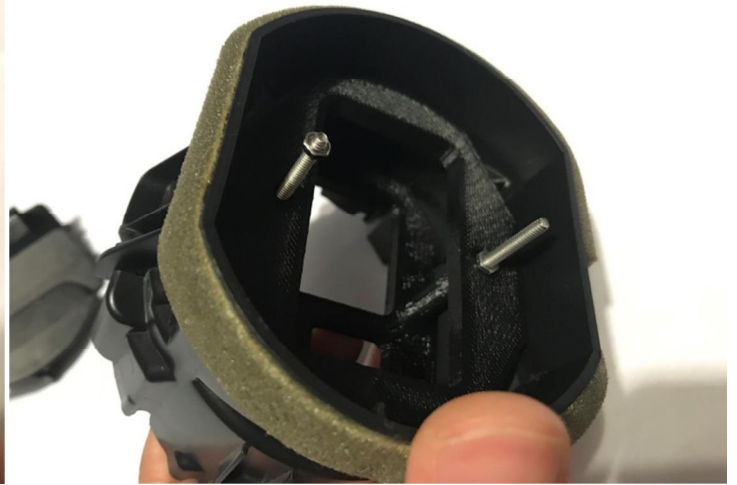
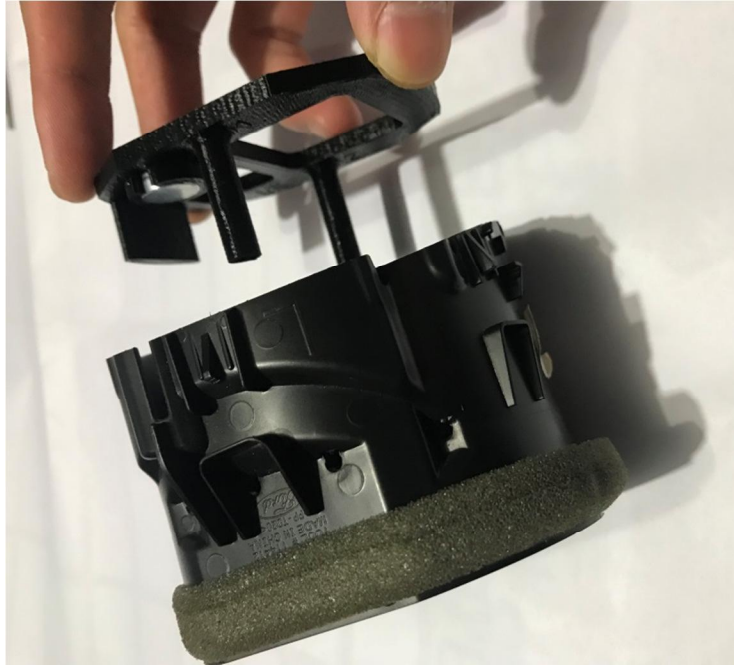

Step 5: Insert vent back into dash trim piece by following Step 1 in reverse.



Step 6: Clip on adapter piece to nGauge as seen below.



**Step 7: Attach wiring harness to back of nGauge, insert nGauge with adapter into vent, and let the magnet catch.
Enjoy the ability to mount and un-mount your nGauge quick and easily!**

